

## EVORA - 600 Floor Mounted Double Drawer Unit Installation & Aftercare Instructions

### Drawer Adjustment Procedures

1. The unit has drawers which can be adjusted up and down. To do so, firstly remove the four screws from the underside of the drawer runners. There is a dial that can be used to adjust the height of the drawers towards the front of the drawer. When the drawer is at the desired height, re-insert the screws into the drawer to secure into the new position.
2. Once the furniture unit is secured, plumb in the basin and secure to the unit using a silicone sealant (not provided).

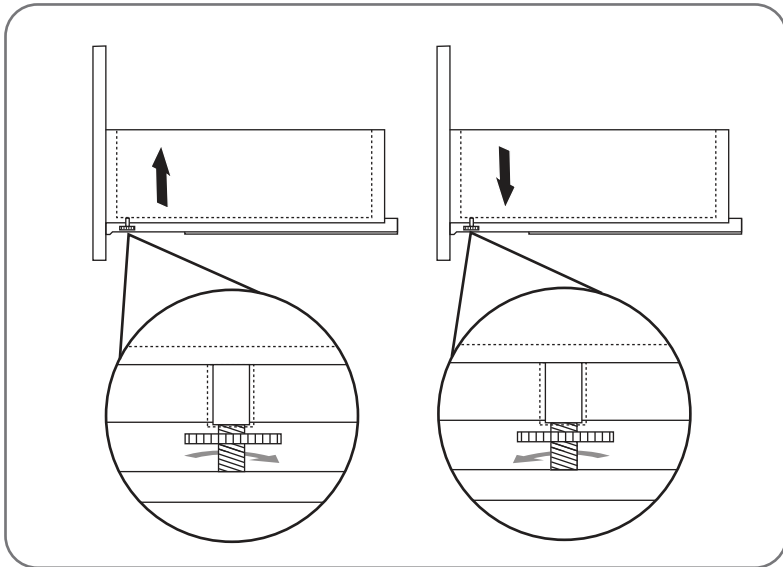

### Aftercare

We recommend that after use, you wipe away any water splashes or condensation from the furniture. Excessive exposure to water will deteriorate the furniture and can damage it. All bathrooms should be well ventilated with a suitable extractor fan. When cleaning, use a soft damp cloth only. Use a wax free polish if one must be used.

Do NOT scrub or scour the unit, or use any abrasive cleaning agents.

### Customer Services

Soakology, Unit 5, Brassmill Lane Enterprise Centre, Bath, BA1 3JN

t. 0845 862 9888 e. [contact@soakology.co.uk](mailto:contact@soakology.co.uk) w: [www.soakology.co.uk](http://www.soakology.co.uk)