



FLO - Freestanding Bath / Shower Mixer Installation & Aftercare Instructions

Retain for future reference



Customer Services

Soakology, Unit 5, Brassmill Lane Enterprise Centre Brassmill Lane, Bath, BA1 3JN
t. 0845 862 9888 e. contact@soakology.co.uk w: www.soakology.co.uk

Part of Total Bathroom Enterprises Ltd
VAT No. 153612626 Company No. 8260845

FLO - Freestanding Bath / Shower Mixer Installation & Aftercare Instructions

Installation Procedures

Prior to installation flush out the pipe work to remove debris and then ensure the water supply is turned off.

Refer to diagram and ensure all components are present.

1. Position the connection plate (A) on to the floor in a suitable position that allows easy assembly of the flexible hoses and the water supply.
2. Ensuring that the circular base plate cover (B) is on the column of the bath mixer, screw the base plate (C) to the base of the bath / shower mixer as shown in Figure 2.
3. Connect the bath / shower mixer column and base plate to the connection plate and floor using the fixings provided. Ensure that the water supply pipes (D) are connected at the same time.
4. Connect the flexible hoses to the mains supply. Turn the water supply back on to check the water is flowing correctly through the bath mixer and shower head. Check the connections for leaks.
5. Lower the base plate cover (B) over the fittings.

Aftercare Instructions

Whilst the item has a high quality durable finish, it should nevertheless be treated with care. Surfaces should be cleaned only using a soft damp cloth and clean water and dried using a soft cotton cloth. Bath cleaning products, even non scratch ones could damage the finished surface.

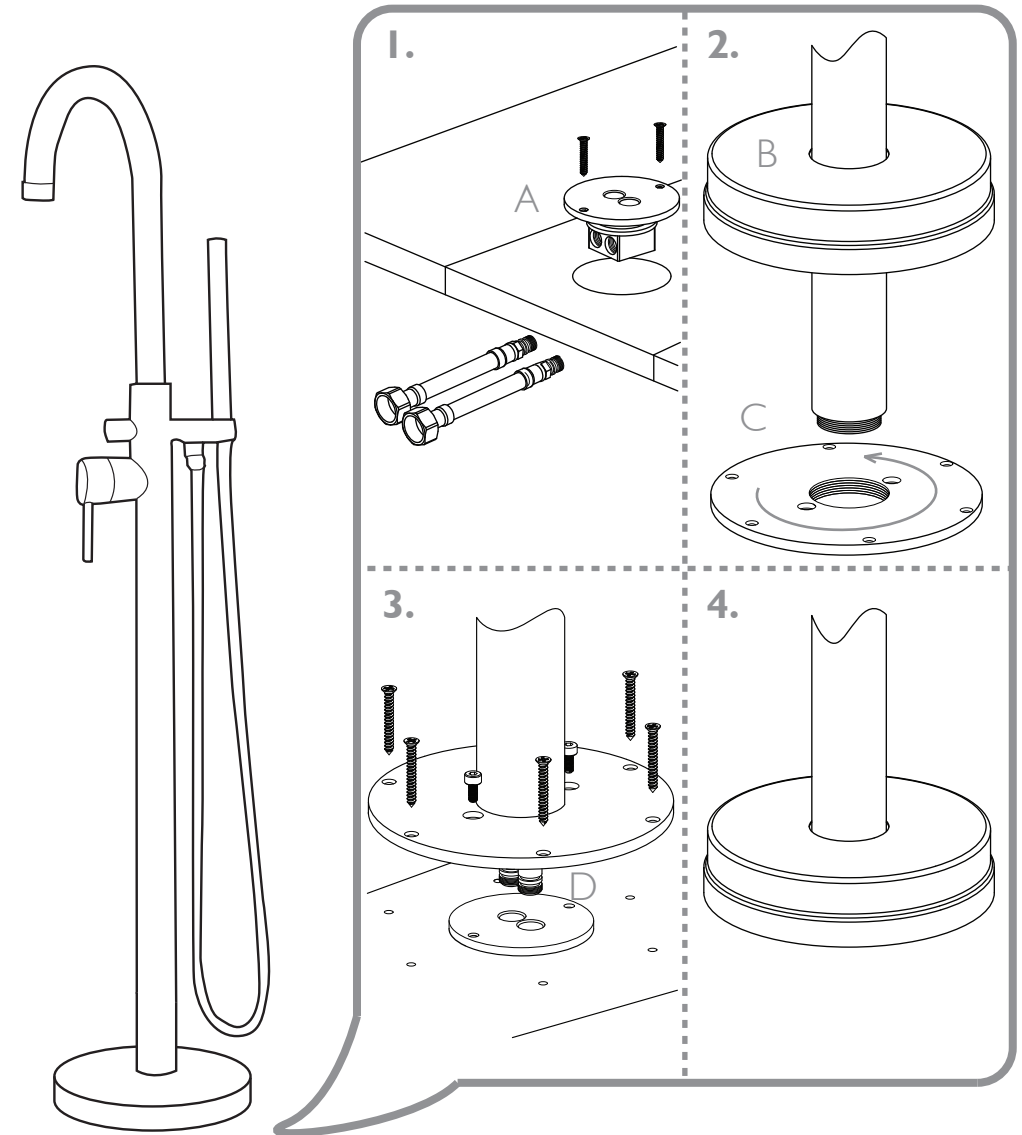

Customer Services

Soakology, Unit 5, Brassmill Lane Enterprise Centre Brassmill Lane, Bath, BA1 3JN
t. 0845 862 9888 e. contact@soakology.co.uk w: www.soakology.co.uk